

版次 1	变更摘要 增加料号说明	日期 2015/1/28	序号	品名	材质
			①	1.0K型胶芯 (H2.5)	LCP UL94V-0 本色
			②	1.0K型下接端子 (H2.5)	磷青铜/表面镀锡
			③	1.0K型卧式后盖 (H2.5)	LCP UL94V-0 黑色
			④	1.0K型卧式焊片 (H2.5)	黄铜/表面镀锡

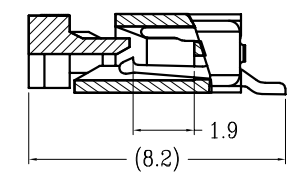
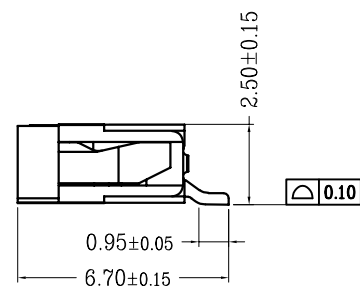
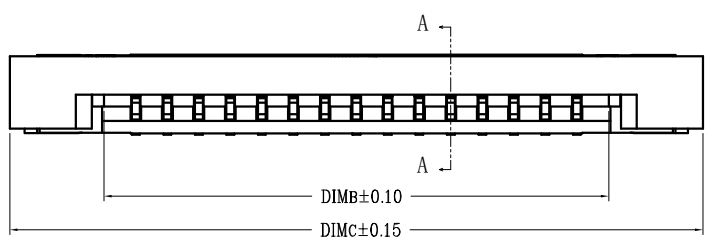
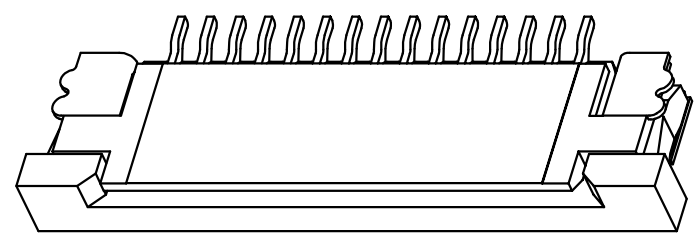
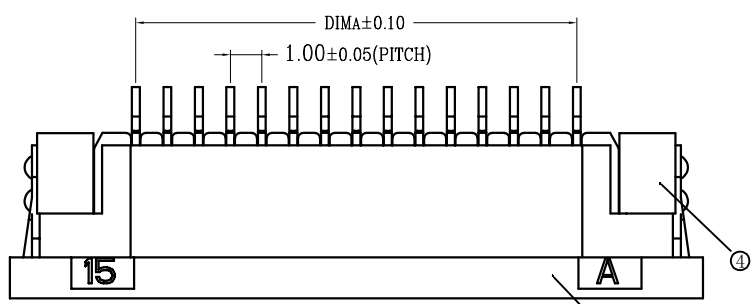

SECTION A-A

KCT	DIM A	DIM B	DIM C
4	3.00	5.03	11.00
5	4.00	6.03	12.00
6	5.00	7.03	13.00
7	6.00	8.03	14.00
8	7.00	9.03	15.00
9	8.00	10.03	16.00
10	9.00	11.03	17.00
11	10.00	12.03	18.00
12	11.00	13.03	19.00
13	12.00	14.03	20.00
14	13.00	15.03	21.00
15	14.00	16.03	22.00
16	15.00	17.03	23.00
17	16.00	18.03	24.00
18	17.00	19.03	25.00
19	18.00	20.03	26.00
20	19.00	21.03	27.00
21	20.00	22.03	28.00
22	21.00	23.03	29.00
23	22.00	24.03	30.00
24	23.00	25.03	31.00
25	24.00	26.03	32.00
26	25.00	27.03	33.00
27	26.00	28.03	34.00
28	27.00	29.03	35.00
29	28.00	30.03	36.00
30	29.00	31.03	37.00
31	30.00	32.03	38.00
32	31.00	33.03	39.00
33	32.00	34.03	40.00
34	33.00	35.03	41.00
35	34.00	36.03	42.00
36	35.00	37.03	43.00
37	36.00	38.03	44.00
38	37.00	39.03	45.00
39	38.00	40.03	46.00
40	39.00	41.03	47.00

适用线路板

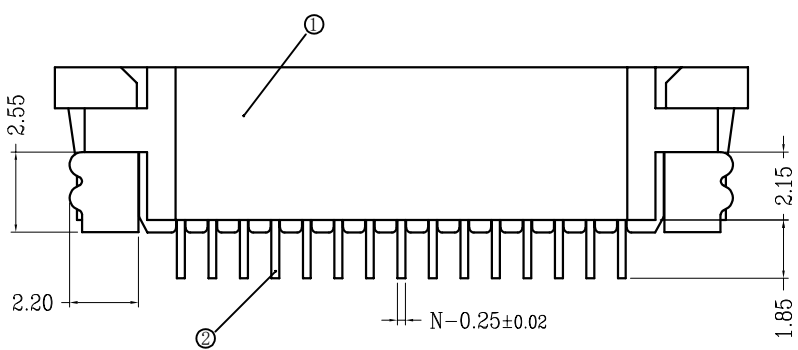
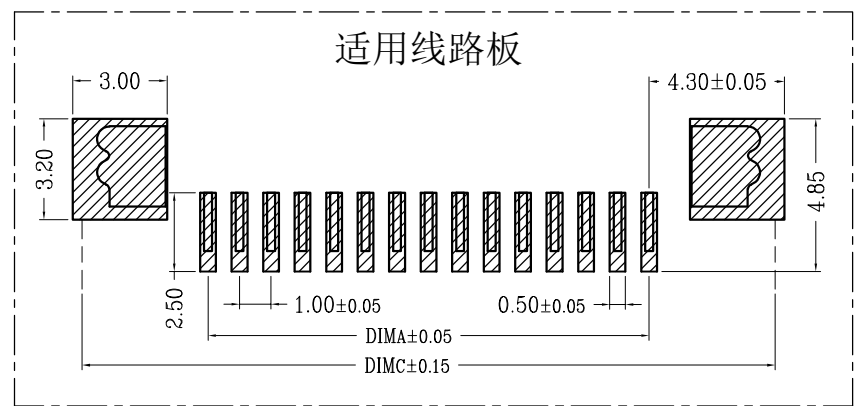

技术指标:

1. 塑件表面应光洁、无毛边、无明显收缩、缺陷、裂纹等现象。
2. 温度范围: $-25^{\circ}\text{C} \sim 85^{\circ}\text{C}$ 。
3. 额定电压: 50V, AC/DC(等效)。
4. 接触电阻: $\leq 0.03\Omega$ 。
5. 绝缘电阻: $\geq 500M\Omega$ 。
6. 产品料号:

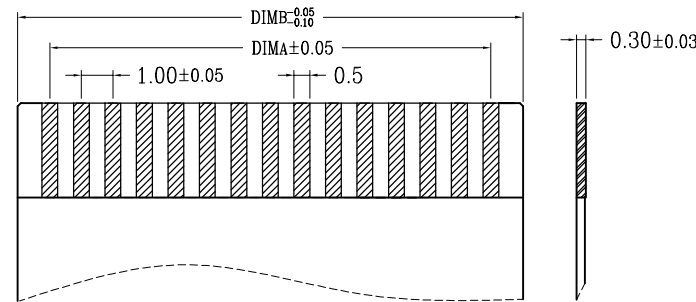
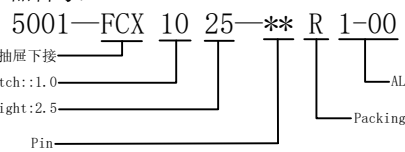

适用扁平线

一般公差(TOLERANCE)	
X ±0.50	XX ±1.0
X ±0.20	XXX ±0.05
ANGLES ±1°	

东莞市文章济美电子有限公司

品名(TITLE) 1.0 Pitch K型卧式下接(H=2.5)	制图(DR) Anlan
料号(DWG.NO) 5001-FCX1025-**-R1-00	校对(CHEK) 王涛
比例(SCALE) 1:1	审核(APPD) 黄志明
单位(UNITS) mm	张数(SHEET) 1 OF 1
	SIZE A4
	REV A